





© Lauren Slusher



© Suzanne Cordeiro



© Suzanne Cordeiro



“Waterloo Park and its world-class amenities were designed and built using environmentally friendly principles and practices — we further that impact by coupling with family-friendly programming designed to educate, inspire and encourage sustainability in our community every day.”

–Jesús Aguirre, Waterloo Greenway CEO

CASE STUDY WATERLOO PARK AND MOODY AMPHITHEATER

RATING:



TOP FEATURES:

- » Earned all Water Category points plus three innovation points, saving more than 1.1 million gallons annually using reclaimed water for flush fixtures and irrigation
- » 1.5 miles of hike-and-bike trails
- » Educational signage and tours
- » 100% renewable wind energy
- » Provides ecosystem services by using green infrastructure to treat stormwater on site (>100% water quality volume) and hosting native vegetation including 90,000 plants and 500 trees
- » 36% energy savings compared to code

PROJECT DESCRIPTION:

Waterloo Park is an 11-acre green space that hosts a range of landscape experiences for play, leisure and celebration of the natural environment. The park is part of the greater Waller Creek District, a partnership between the City of Austin, the Waterloo Greenway Conservancy and the Waller Creek Local Government Corporation. An accessible trail network weaves through the site, connecting gardens, water features, gathering spaces and mature trees. The park also features a central lawn to create a new civic space that opens toward the Moody Amphitheater. Open year round, this venue provides a dynamic music and arts experience in an urban park with diverse entertainment options that embody the values of the community.

ENVIRONMENTAL FEATURES:

Waterloo Park is the first phase of a larger restoration of Waller Creek. The project team's commitment to improving environmental conditions and stewardship of the creek drove many of the design decisions. The project contributes to an ecologically robust and resilient urban creek, riparian corridor and park system, while protecting and caring for the creek's ecosystem.

Water management is a vital element of the park design. The site features green roofs, wetlands and rain gardens that absorb and filter rainwater and runoff. This reduces the amount and speed of stormwater that makes its way into the creek, helping to mitigate flash-flooding and erosion, recharging the groundwater and improving the quality of the water that eventually moves into the waterway. Non-potable water sourced primarily from the city's reclaimed water loop supplies the irrigation system and the flush fixtures in the park's restrooms.

The design team sourced local materials, including those made with recycled content, to lessen the project's embodied carbon and energy. A hauler certified by the Recycling Certification Institute (RCI) managed construction waste, providing enhanced understanding of debris streams, including how much material is ultimately recycled.

In keeping with the Waterloo Greenway Conservancy's initiative to showcase artwork from around the world, Waterloo Park also features a 6,500 sq. ft. mural by renowned Venezuelan artist Arturo Herrera.

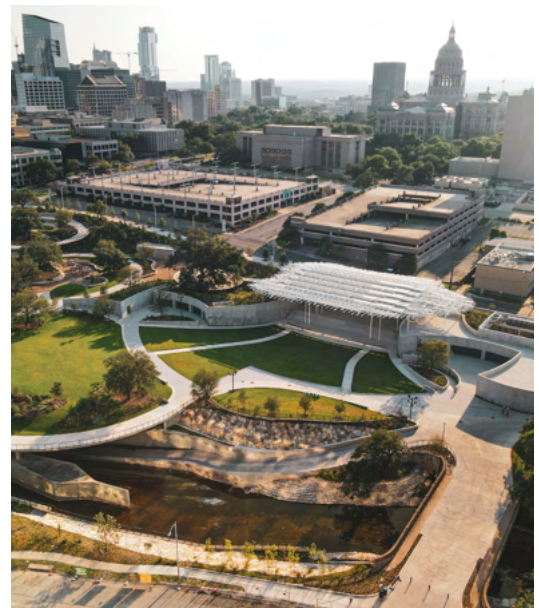

© John Sutfin

PROJECT PROFILE:

Owner » City of Austin/Waterloo Greenway Conservancy
Architect » Thomas Phifer and Partners
Landscape Architect » Michael Van Valkenburgh Associates
Construction Manager » DPR Construction
Structural Engineer, Moody Amphitheater » Guy Nordenson and Associates
MEP Engineer » Altieri Sebor Wieber
Architectural Lighting, IT and Acoustical Consulting » ARUP
Sustainability Consultant » Studio 8 Architects
Theater A/V » Theatre Consultants Collaborative
Waterproofing Consultant » Simpson Gumpertz & Heger
Concrete Consultant » Reg Hough Associates
Wind Modeling » RWDI
Commissioning Agent » Shah Smith
Civil Engineer » WGI
Geotechnical Engineering and Materials Testing » Terracon
Landscape Architect, Local » dwg
Landscape Contractor » CleanScapes
Architect, Park Restroom Building » Michael Hsu Office of Architecture
Structural Engineer, Park and Bridges » Architectural Engineers Collaborative (AEC)
MEP, Restroom Building and Park Electrical » EEA
Park Lighting Design » Tillett Lighting Design Associates
Accessibility Consultant » Altura Solutions
Irrigation Design » James Pole
Local Ecologist » Lady Bird Johnson Wildflower Center
Hydrologist » LimnoTech
Soil Scientist » Olsson Associates
Large Tree Relocation » Environmental Design
Consulting Arborist » Treage
Surveyor » McGray & McGray Land Surveyors
Branding and Signage Design » Bruce Mau Design
Signage Fabricator and Installer » Austin Architectural Graphics
Cost Consultant » Vermuelens
Public Space Management Consultant » ETM Associates
Economic Impact Consultant » HR&A Advisors
Permit Expediter » Austin Permit Service



© Ryan Vestil

Austin Energy Green Building cultivates innovation in building and transportation for the enrichment of the community's environmental, economic and human well-being.

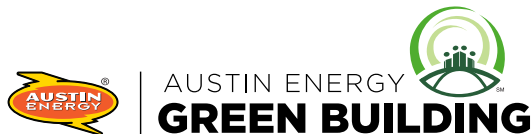

Location » 4815 Mueller Blvd. Austin, TX 78723-3573 | **Phone »** 512.482.5300 | **E-mail »** greenbuilding@austinenenergy.com

Web » greenbuilding.austinenenergy.com | **Facebook »** facebook.com/aegreenbuilding